

SYSTEM ADVANTAGES

Durable, symmetrical gutter profile

A thickened, custom designed gutter profile with high mechanical strength and resistance to permanent deformation.



Reliable, «double-t» bracket construction

Allows the product to bear the weight of very high impact loads.



Custom solutions

The adjustable gutter angle makes the system suitable for installation on roofs with custom design.

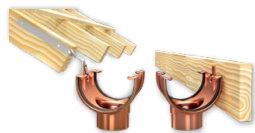

Versatility

The combination of the half round gutter - 125 mm and pipe system size options of Ø80 or Ø100 makes the system compatible with more than 84 % of the roofs.

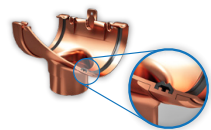

Efficient drainage capacity

The in-built silicone gaskets perfectly lining each connecting element contributes to the highly efficient drainage capacities of the system.

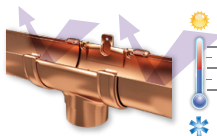

Uv rays and temperature resistance

The newly-developed polymer has proven resistance indicators to the action of the UV rays, aggressive chemicals and extreme temperature fluctuations.



Quick and easy installation

All gutter components are attached through a fast and reliable single-click mechanism-eliminating the need of specialized tools.



Warranty

All components of system REGENAU come with warranty subject to the warranty policy and proper installation works.

DISTRIBUTION

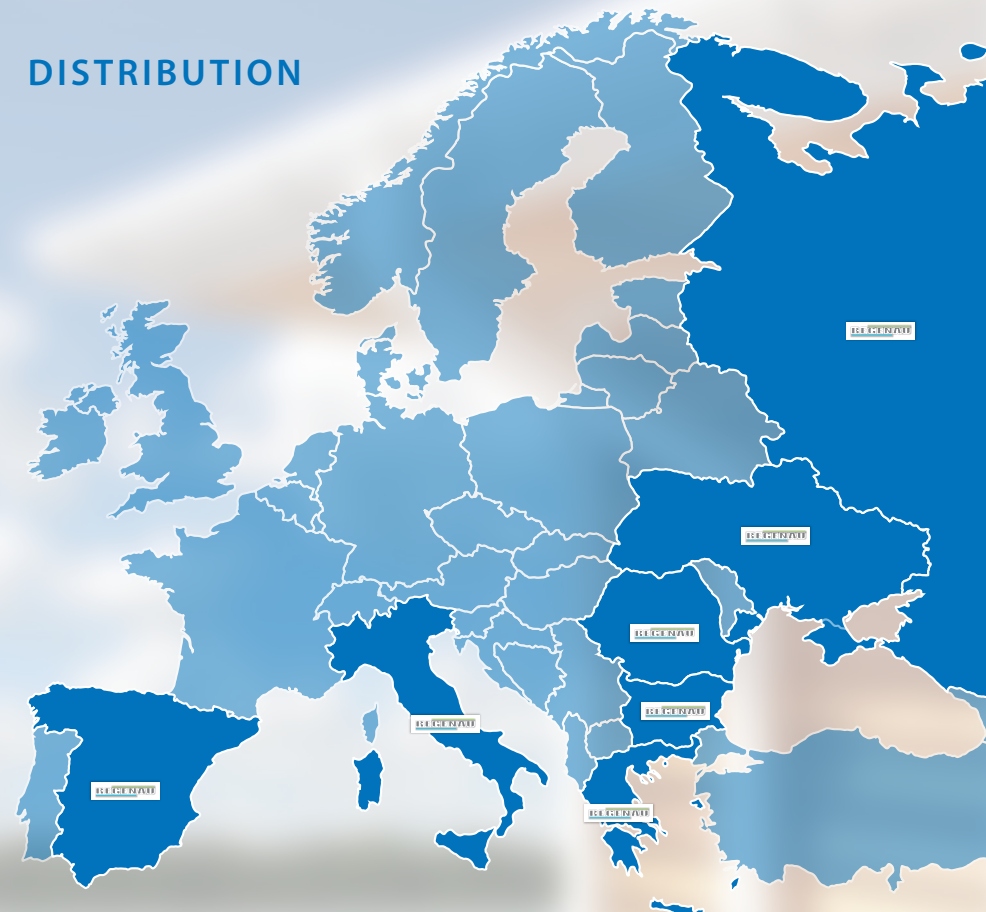

www.regenau.com
export@regenau.com

Distributor:



REGENAU

GENAU WENN ES REGNET

PVC GUTTER SYSTEM
HR 125 - 100/80 MM



REGENAU

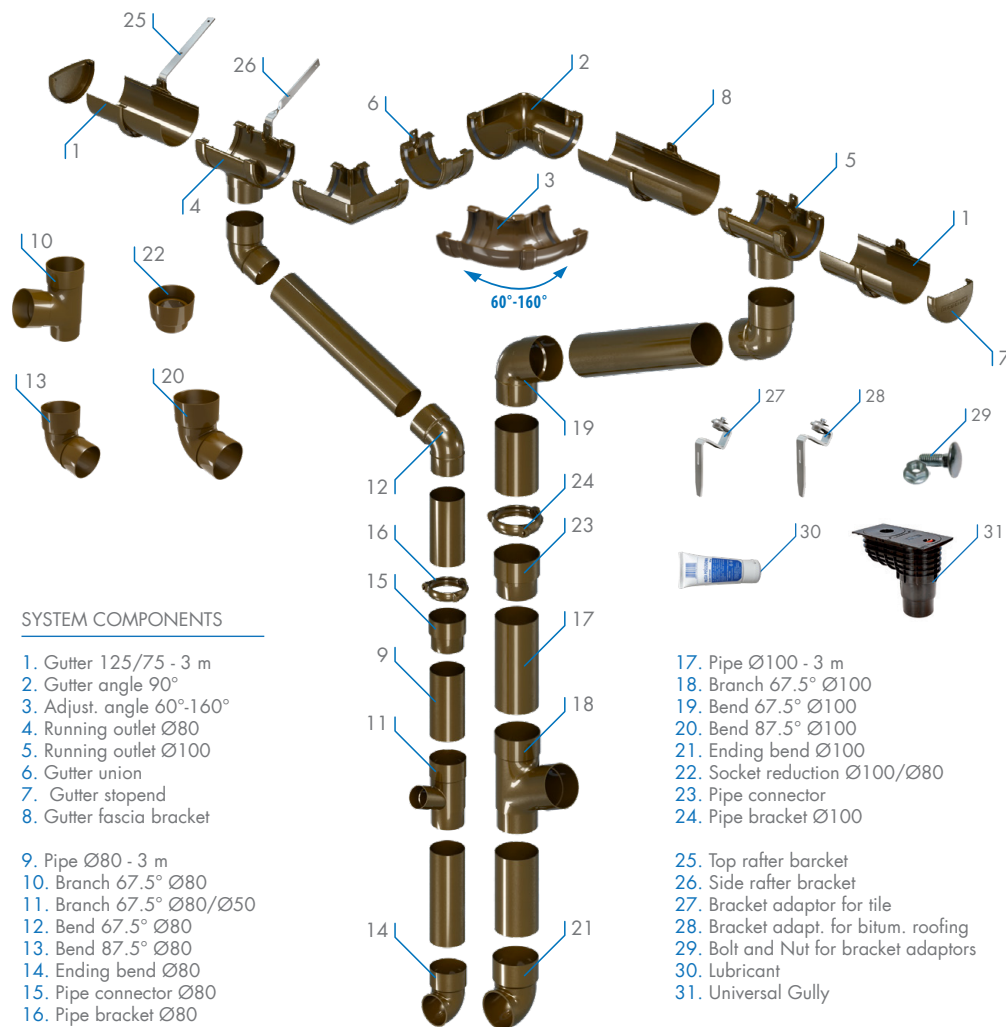

SYSTEM COMPONENTS

1. Gutter 125/75 - 3 m
2. Gutter angle 90°
3. Adjust. angle 60°-160°
4. Running outlet Ø80
5. Running outlet Ø100
6. Gutter union
7. Gutter stopend
8. Gutter fascia bracket
9. Pipe Ø80 - 3 m
10. Branch 67.5° Ø80
11. Branch 67.5° Ø80/Ø50
12. Bend 67.5° Ø80
13. Bend 87.5° Ø80
14. Ending bend Ø80
15. Pipe connector Ø80
16. Pipe bracket Ø80
17. Pipe Ø100 - 3 m
18. Branch 67.5° Ø100
19. Bend 67.5° Ø100
20. Bend 87.5° Ø100
21. Ending bend Ø100
22. Socket reduction Ø100/Ø80
23. Pipe connector
24. Pipe bracket Ø100
25. Top rafter bracket
26. Side rafter bracket
27. Bracket adaptor for tile
28. Bracket adapt. for bitum. roofing
29. Bolt and Nut for bracket adaptors
30. Lubricant
31. Universal Gully

WARRANTY FOR STANDARD COLORS

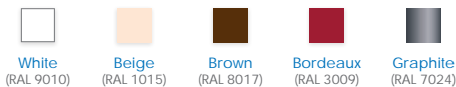

WARRANTY FOR COPPER



INSTALLATION MANUAL

DESIGN

The project of a roof drainage system should be prepared by an authorized designer, considering the requirements of EN 12056-3 and strictly following all national and local standards in building planning. The product is intended for rainwater harvesting from the roofs of residential, administrative and industrial buildings.

ATTENTION!

When the building is located in areas where formation of deep snow cover and /or ice are possible it is strongly advisable to use snow-retention elements to prevent the possible falling of ice/snow that will respectively inflict damage on people or property.

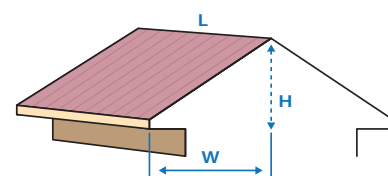

REGENAU FLOW RATES

All calculations acc. to EN 12056-3, based on rainfall intensity of 80 l/m².h

	Outlet positioned at the end	Outlet positioned in the middle
Slope 8 mm/m	2,2 l/sec 100 m²	4,4 l/sec 200 m²
Slope 4 mm/m	1,9 l/sec 85 m²	3,8 l/sec 170 m²
Horizontal	1,6 l/sec 70 m²	3,2 l/sec 140 m²

The effective surface of the roof - **S** can be calculated using the following formula: **S = (W + H/2) * L**, where:
W - is the horizontal distance from the edge of the roof to the projection of the ridge;
H - is the roof height;
L - is the roof length.

STORAGE AND HANDLING

The gutters and pipes should be stored above the ground level on a smooth surface without any roughness or sharp edges. The products should be arranged freely without twisting or bending, and it is not permitted to arrange them in height bigger than 6 layers of packages. The fittings and connecting parts should be stored indoors in their original packages in order to protect the products from damage or pollution. Ventilation should be provided for the products for the period of storage; they should not be wrapped or covered with transparent or opaque foils. To prevent surface scratching of gutters and pipes - do not slide one on top of the other.

GUTTER BRACKET FIXING OPTIONS

All gutters are fixed to the fascia board by gutter fascia brackets. When a fascia board is absent, it is required to use any of the four gutter bracket fixing options: above or on the sides of beams, on bitumen roofing and tiles (see pictures below).

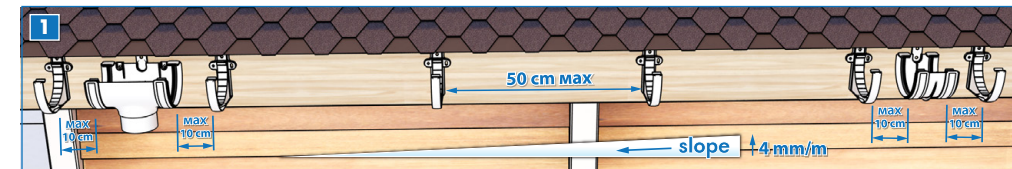
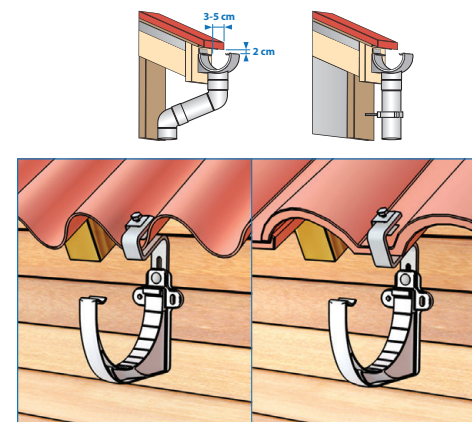
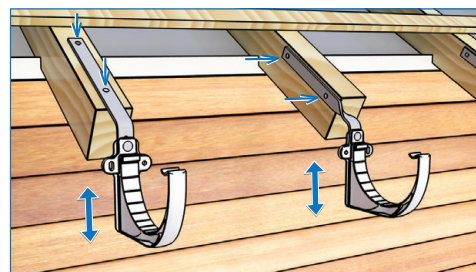

1. Fix the running outlet on the previously marked position, considering the pipe position and gutter slope. Use a cord to determine the gutter slope and install the gutter brackets starting with the utmost, providing a 04% slope, at a maximum distance of 50 cm from each other. We recommend the fixation of a gutter bracket on the sides of each gutter fitting (angle, union, running outlet) at a maximum distance of 10 cm. To achieve optimal fastening, fix to the fascia board using screws 5x30 mm.

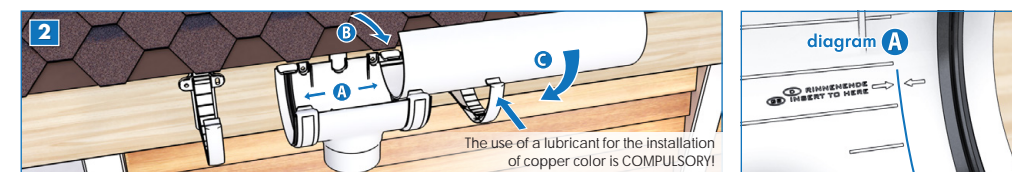

2. Measure and cut to the necessary gutter lengths, taking into account the insertion marks of the fittings, marked with **A**. To install the gutter, position one of its edges as shown on diagram **B**, ease the other edge (diagram **C**) under the hook of the gutter fascia bracket, until the gutter snaps into all brackets and/or fittings. All gutter fittings, excluding the end caps, are lined with inbuilt silicon gaskets to ensure leakage-free joints. DO NOT use glue on the fittings with silicone gaskets. For standard colors we advise to apply a fine layer of lubricant on each gasket as to facilitate the gutter movement due to thermal contractions and expansions.

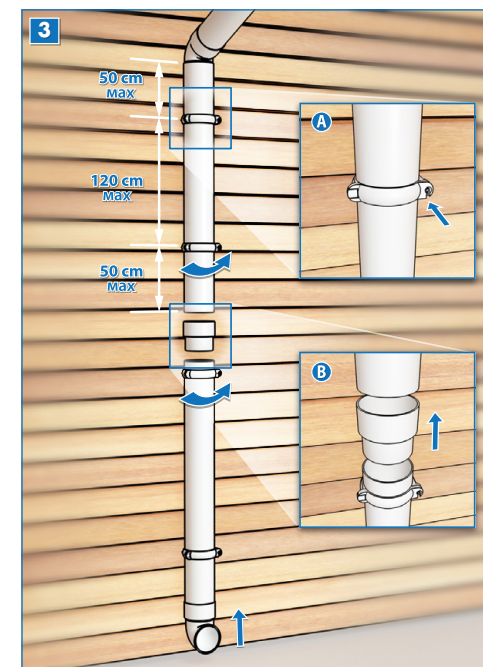

3. Fix the pipe brackets to the wall at a maximum distance of 120 cm from each other and 50 cm from each pipe edge, by using the appropriate screw size depending on the thickness of the stucco and the wall insulation. Line the pipe in the bracket bed, close the front part and fasten with provided screws. To allow for thermal movement it is recommended to leave a 7-10 mm clearance between the edge of each pipe and the upper (wide) part of the connecting fittings. Install a pipe bracket immediately after each socket.

By using our online, user-friendly calculator, you can estimate your gutter installation individual project.
www.regenau.com/en/Calculator

